

Builder's hardware for timber and PVC windows and patio doors

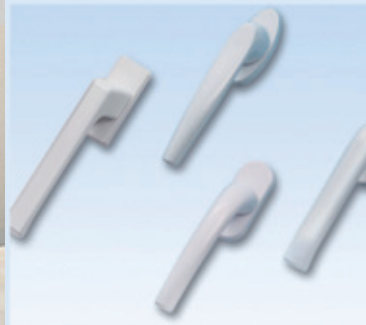

# H/K

**!NNOVATION**  
NEW & EXCLUSIVE AT G.U-BKS

Parallel slide and tilt fittings  
flush with the floor – barrier free



**Qualité:  
G.U certifié avec succès**

La norme DIN ISO 9001 définit les exigences à la structure et le mode de travail de l'entreprise et de sa gestion de qualité.

En 1995 le comité AGQS e.V. a certifié l'introduction avec succès d'un système de management de qualité conforme à la norme DIN ISO 9001 dans la Société Gretsch-Unitas GmbH Baubeschläge.

La fabrication de produits de qualité est un but permanent pour G.U. Le certificat confirme que la coopération interne de la Société – du développement des produits jusqu'à la distribution et le service pour les clients – correspond également à ce but.

**Qualität:  
G.U erfolgreich zertifiziert**

DIN ISO 9001 definiert die Anforderungen an die Struktur und Arbeitsweise des Unternehmens und seines Qualitätsmanagements.

1995 bescheinigte die AGQS e.V. der Gretsch-Unitas GmbH Baubeschläge die erfolgreiche Einführung eines Qualitätssicherungssystems entsprechend DIN ISO 9001.

Die Herstellung von Qualitätsprodukten ist für G.U ein beständiges Anliegen. Die Zertifizierung bestätigt, dass auch die betriebsinternen Abläufe – von der Entwicklung bis zum Vertrieb und Kundenservice – mit diesem Anliegen übereinstimmen.

**Quality:  
G.U successfully certified**

DIN ISO 9001 defines the requirements to structure and working methods of the enterprise and its quality management.

In 1995 the committee AGQS e.V. has certified the successful introduction of a quality management system according to DIN ISO 9001 in the company Gretsch-Unitas GmbH Baubeschläge.

The production of quality hardware is a permanent concern for G.U. The certificate confirms that the internal cooperation of the company – from product development to distribution and customer's service – also corresponds to this concern.

## Parallel slide and tilt fittings G.U-966/100 oZ bb – flush with the floor

### Maximum use of space and living comfort

Mounted flush with the floor level, the parallel slide and tilt system G.U-966/100 oZ offers extra living comfort. Not only children, the elderly, or wheelchair and walking frame users, but everyone to whom convenient living is important will appreciate passing through a patio door without tripping hazard.

Naturally, this new fitting type offers all the benefits of the standard parallel slide and tilt system such as, e.g., simple one-handle operation and upgradable security with additional burglary inhibiting components.

- Usable for all standard timber and PVC profiles (scheme A)
- Unhindered passage with the low G.U threshold DKS complying with the requirements of "Accessible Dwellings" to DIN 18025.
- Easy operation via lever handle, same operating principle as that of the standard parallel slide and tilt fittings from G.U.
- Same central locking mechanism as with all G.U parallel slide and tilt "oZ" systems.

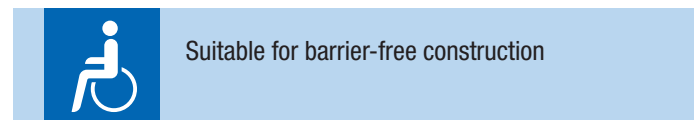

### Application of G.U-966/100 oZ bb:

- 2-sash parallel slide and tilt door elements
- 2-sash parallel slide and tilt window elements with running rails and gliding rails, each.

### Locking mechanisms:

#### Parallel slide and tilt locking gear G.U-966/100 oZ bb

The locking mechanism G.U-966/100 oZ bb features one-handle operation, the parallel offset of the sliding sash is 118 mm. The gears come with 15 mm backset for handle DIRIGENT [1], or as lockable gears with 25 to 50 mm backset and profile cylinder bore. All locking parts are designed for a 16 mm fitting groove. The locking pins of gear and corner transmission are adjustable. From sash rebate widths over 851 mm and sash rebate heights over 751 mm, additional centre locks are used.

The corner transmissions are provided with rust-proof 4-leaf stainless steel springs.

SRW 650-1600 mm, SRH 700-2350 mm.

[1] Further handle types can be found in the order catalogues "H" (Timber) and "K" (PVC), chapter 3 each.

### Runners, profiles and accessories

#### Parallel slide and tilt fittings G.U-966/100 oZ bb

Floor-flush parallel slide and tilt fittings with 4-wheel carriages running at the top and clamp fixed connecting rods for windows and patio doors with sash widths SW from 640 to 1600 mm, sash heights SH from 700 to 2350 mm, and sash weights up to 100 kg. Wheels consisting of deep groove ball bearings with plastic sheathing.

In combination with G.U floor threshold DKS (installation height < 20 mm) ideally suited for barrier-free construction.

The basic product information can be found in the order catalogues "H" (Timber – WP00020-04-1-1, edition 09.2009) and "K" (PVC – WP00030-04-1-1, edition 09.2009), pages 1.13 to 1.16, each.

## Contents

### Locking gears

Locking gear D 15	4
Locking gear AP, lockable	5

### Runners, profiles and accessories

G.U-966/100 oZ bb	6
-------------------	---

### Locking plates and positioning plates

Locking plates and positioning plates for DKS thresholds	7
Adapters for locking plates and positioning plates for DKS thresholds	7
Important advice	7

Handle inside – gear 15, groove position 9 and 13

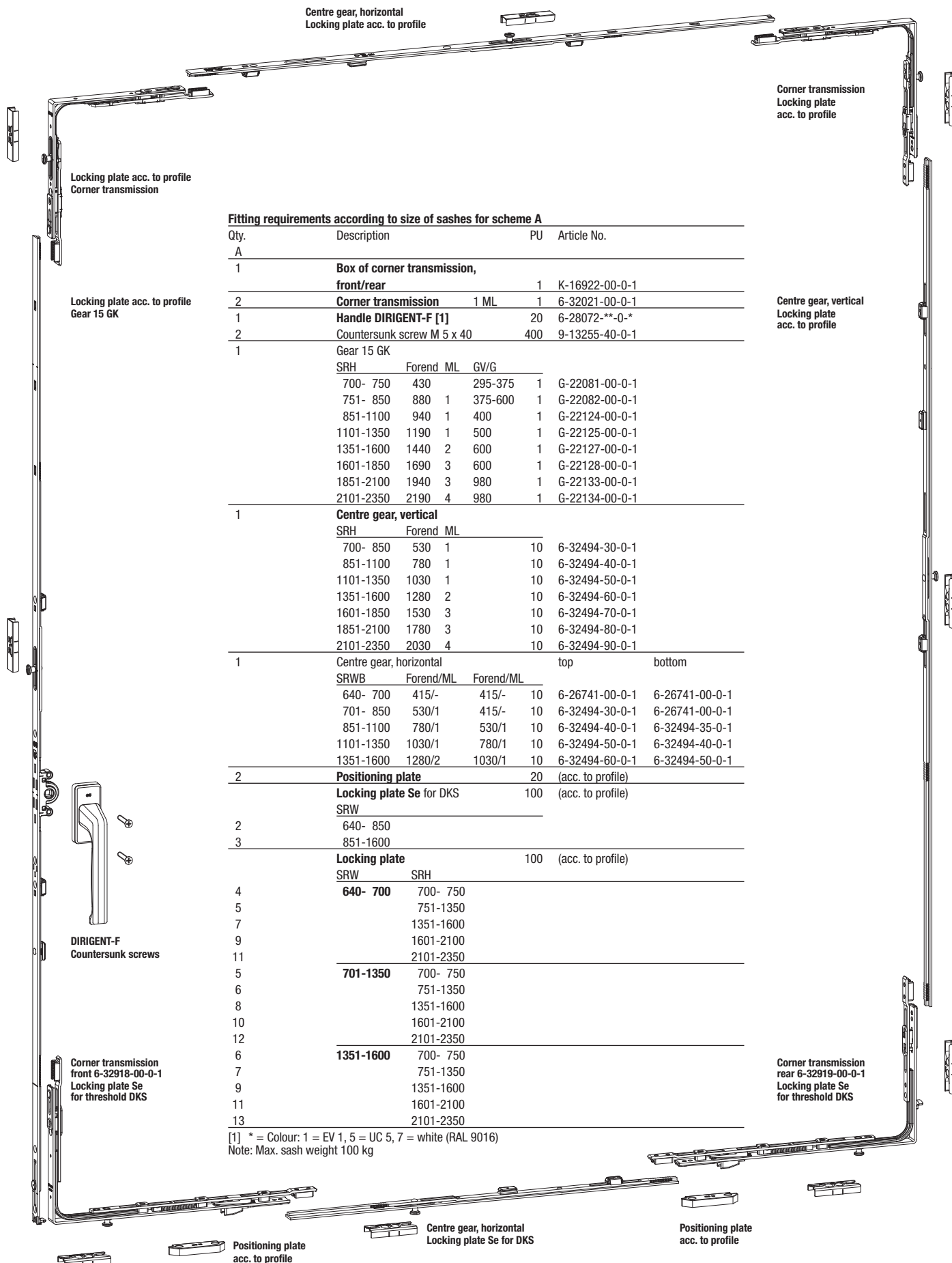

**Fitting requirements according to size of sashes for scheme A**

Qty.	Description	PU	Article No.
A			
1	<b>Box of corner transmission, front/rear</b>	1	K-16922-00-0-1
2	<b>Corner transmission</b>	1 ML	1 6-32021-00-0-1
1	<b>Handle DIRIGENT-F [1]</b>	20	6-28072-**-0-*
2	Countersunk screw M 5 x 40	400	9-13255-40-0-1
1	<b>Gear 15 GK</b>		
	SRH      Forend ML      GV/G		
	700- 750    430            295-375    1		G-22081-00-0-1
	751- 850    880    1            375-600    1		G-22082-00-0-1
	851-1100    940    1            400            1		G-22124-00-0-1
	1101-1350    1190    1            500            1		G-22125-00-0-1
	1351-1600    1440    2            600            1		G-22127-00-0-1
	1601-1850    1690    3            600            1		G-22128-00-0-1
	1851-2100    1940    3            980            1		G-22133-00-0-1
	2101-2350    2190    4            980            1		G-22134-00-0-1
1	<b>Centre gear, vertical</b>		
	SRH      Forend ML		
	700- 850    530    1            10		6-32494-30-0-1
	851-1100    780    1            10		6-32494-40-0-1
	1101-1350    1030    1            10		6-32494-50-0-1
	1351-1600    1280    2            10		6-32494-60-0-1
	1601-1850    1530    3            10		6-32494-70-0-1
	1851-2100    1780    3            10		6-32494-80-0-1
	2101-2350    2030    4            10		6-32494-90-0-1
1	<b>Centre gear, horizontal</b>		
	SRWB      Forend/ML      Forend/ML		
	640- 700    415/-            415/-            10		6-26741-00-0-1    6-26741-00-0-1
	701- 850    530/1            415/-            10		6-32494-30-0-1    6-26741-00-0-1
	851-1100    780/1            530/1            10		6-32494-40-0-1    6-32494-35-0-1
	1101-1350    1030/1            780/1            10		6-32494-50-0-1    6-32494-40-0-1
	1351-1600    1280/2            1030/1            10		6-32494-60-0-1    6-32494-50-0-1
2	<b>Positioning plate</b>	20	(acc. to profile)
	<b>Locking plate Se for DKS</b>	100	(acc. to profile)
	SRW		
2	640- 850		
3	851-1600		
	<b>Locking plate</b>	100	(acc. to profile)
	SRW      SRH		
4	<b>640- 700</b>	700- 750	
5		751-1350	
7		1351-1600	
9		1601-2100	
11		2101-2350	
5	<b>701-1350</b>	700- 750	
6		751-1350	
8		1351-1600	
10		1601-2100	
12		2101-2350	
6	<b>1351-1600</b>	700- 750	
7		751-1350	
9		1351-1600	
11		1601-2100	
13		2101-2350	

[1] \* = Colour: 1 = EV 1, 5 = UC 5, 7 = white (RAL 9016)  
 Note: Max. sash weight 100 kg

Handle inside – lockable gear AP, groove position 9 and 13

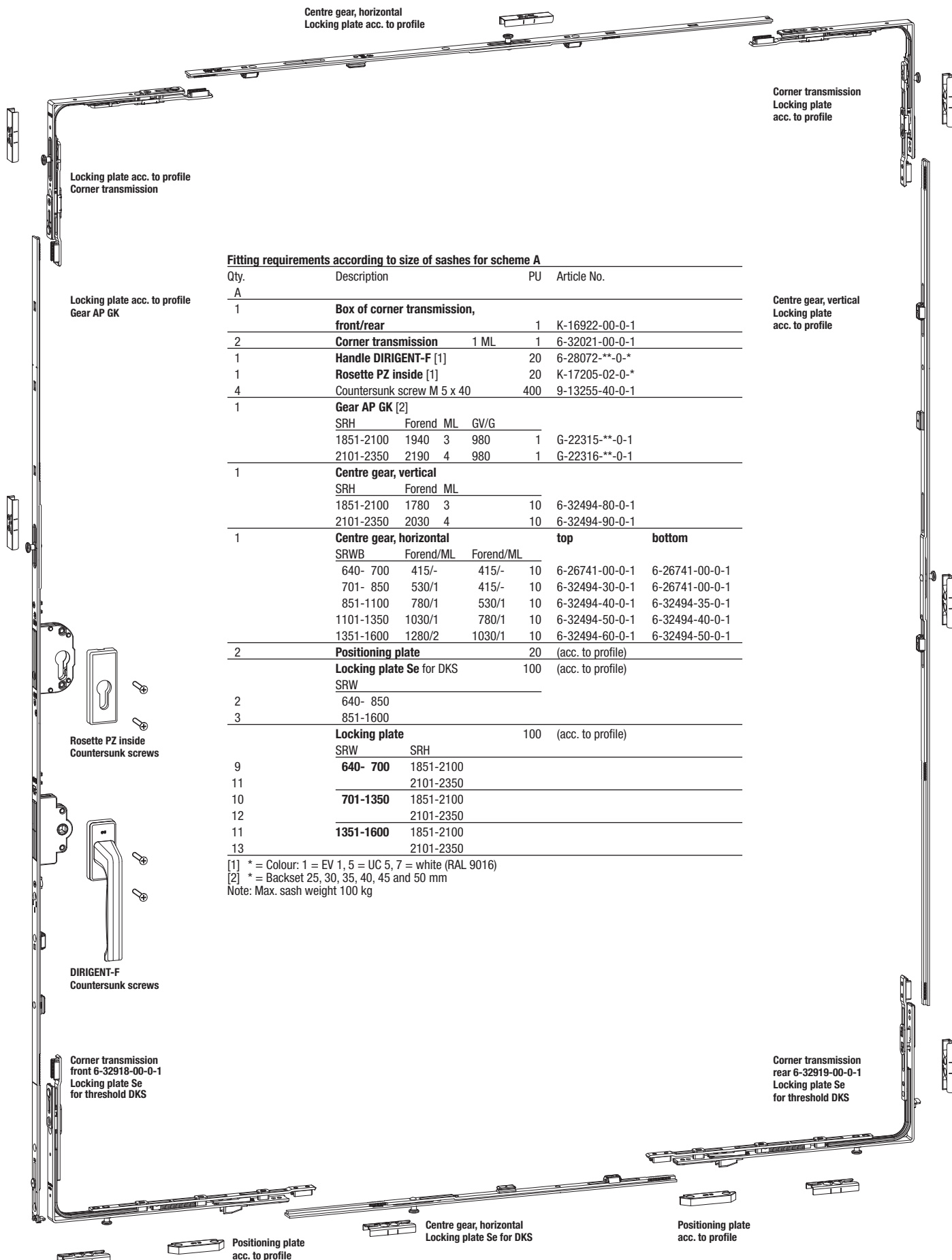

**Fitting requirements according to size of sashes for scheme A**

Qty.	Description	PU	Article No.
<b>A</b>			
1	<b>Box of corner transmission, front/rear</b>	1	K-16922-00-0-1
2	<b>Corner transmission</b> 1 ML	1	6-32021-00-0-1
1	<b>Handle DIRIGENT-F</b> [1]	20	6-28072-**-0-*
1	<b>Rosette PZ inside</b> [1]	20	K-17205-02-0-*
4	Countersunk screw M 5 x 40	400	9-13255-40-0-1
1	<b>Gear AP GK</b> [2]		
	SRH Forend ML GV/G		
	1851-2100 1940 3 980	1	G-22315-**-0-1
	2101-2350 2190 4 980	1	G-22316-**-0-1
1	<b>Centre gear, vertical</b>		
	SRH Forend ML		
	1851-2100 1780 3	10	6-32494-80-0-1
	2101-2350 2030 4	10	6-32494-90-0-1
1	<b>Centre gear, horizontal</b>		
	SRWB Forend/ML Forend/ML		
	640- 700 415/- 415/-	10	6-26741-00-0-1 6-26741-00-0-1
	701- 850 530/1 415/-	10	6-32494-30-0-1 6-26741-00-0-1
	851-1100 780/1 530/1	10	6-32494-40-0-1 6-32494-35-0-1
	1101-1350 1030/1 780/1	10	6-32494-50-0-1 6-32494-40-0-1
	1351-1600 1280/2 1030/1	10	6-32494-60-0-1 6-32494-50-0-1
2	<b>Positioning plate</b>	20	(acc. to profile)
	<b>Locking plate Se for DKS</b>	100	(acc. to profile)
	SRW		
2	640- 850		
3	851-1600		
	<b>Locking plate</b>	100	(acc. to profile)
	SRW SRH		
9	<b>640- 700</b> 1851-2100		
11	2101-2350		
10	<b>701-1350</b> 1851-2100		
12	2101-2350		
11	<b>1351-1600</b> 1851-2100		
13	2101-2350		

[1] \* = Colour: 1 = EV 1, 5 = UC 5, 7 = white (RAL 9016)

[2] \* = Backset 25, 30, 35, 40, 45 and 50 mm

Note: Max. sash weight 100 kg

Doors and windows with sash width SW up to 1600 mm and sash weight up to 100 kg

Running rail P 1300  
Control part lh 6-34725-00-L-\*  
rh 6-34725-00-R-\*

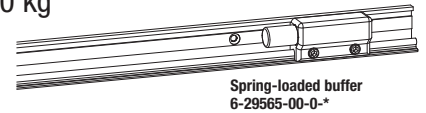
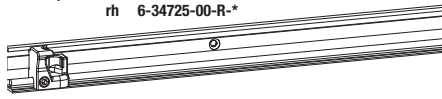

Rod Ø 8 mm  
Anti-lift security device 6-34524-00-0-1  
Guide 6-24764-00-0-1

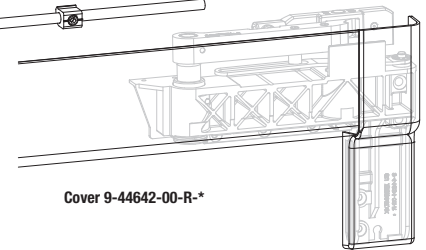
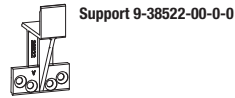
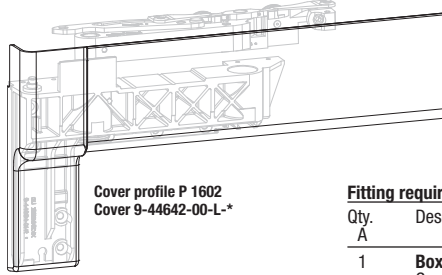

Cover profile P 1602  
Cover 9-44642-00-L-\*

### Fitting requirements according to size of sashes for scheme A

Qty. A	Description	PU	Article No. Handle pos. lh	Handle pos. rh
1	<b>Box of runners G.U-966/100 oZ bb</b> Contents 1 Top runner – front, 1 Top runner – rear 1 Bottom runner – front, 1 Bottom runner – rear 2 Anti-lift security device	1	K-17678-00-L-0	K-17678-00-R-0
1	<b>Bag of control parts G.U-966/100 oZ bb [1]</b> Contents 1 spring-loaded buffer, 1 standard control part, 1 control part "bb" 1 Adapter for gliding rail P 1771	1	K-17679-00-L-*	K-17679-00-R-*
1	<b>Bag of profiles G.U-966/100 oZ bb [1]</b> Contents 2 Rod Ø 8 mm, 1 running rail P 1300 1 Cover rail P 1602, 1 Cover rail P 1773 bottom 1 Gliding rail P 1771, bottom 1 Guide (bag of profiles size 30 and 35) 1 Support (Bag of profiles size 30 and 35) 1 Bag of accessories for G.U-966/100 oZ bb SRW 851-1100 1 K-17680-25-0-* [2] 1351-1600 1 K-17680-35-0-* [3]			
1	<b>Bottom profile DKU</b>	25	9-42791-00-0-*	[4]
1	<b>Threshold DKS 1.1.0</b> , stock length 6000 mm alternative: <b>Threshold DKS 7.1.0</b> , stock length 6000 mm	5	6-32326-00-0-1	
1	<b>Threshold-to-frame connector DKH (pair)</b>	5	H-01004-00-0-1	
2	<b>Adapter for positioning place</b>	1	Groove 9 9-43106-13-0-1	Groove 13 9-43106-13-0-1
	<b>Adapter for locking plate</b>	1	9-43106-09-0-1	9-43106-13-0-1
	SRW			
2	640- 850			
3	851-1600			

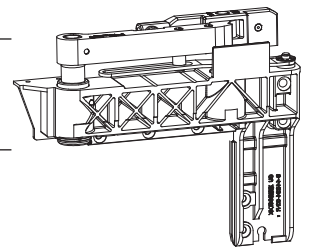

Runner top – rear  
left 6-34523-00-L-0  
right 6-34523-00-R-0

Runner top – front  
left 6-34521-00-L-0  
right 6-34521-00-R-0

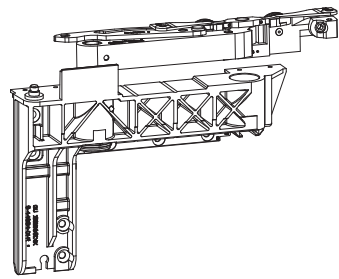

[1] \* = Colour: 1 = EV 1, 5 = UC 5, 7 = white (RAL 9016)

[2] = Available in colours UC 5 and white

[3] = Available in colours EV 1, UC 5 and white

[4] = Available in lengths 1200, 2400, 4800 mm

Note: Profile-specific threshold-to-mullion connector to be ordered separately; use extension profiles DKS

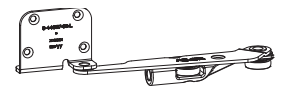

Runner bottom – rear  
left 6-34519-00-L-0  
right 6-34519-00-R-0



Runner bottom – front  
left 6-34518-00-L-0  
right 6-34518-00-R-0

Bottom profile DKU

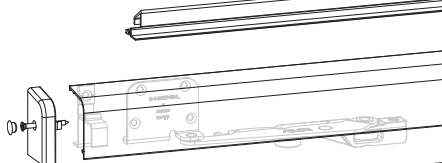

Bottom cover rail P 1773

Support 9-44644-01-0-0  
Rod Ø 8 mm

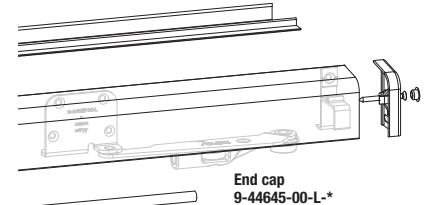

End cap 9-26687-00-0-\*Countersunk screw 9-31151-20-R-1  
End cap 9-44645-00-L-\*

Adapter for positioning plate  
Adapter for locking plate

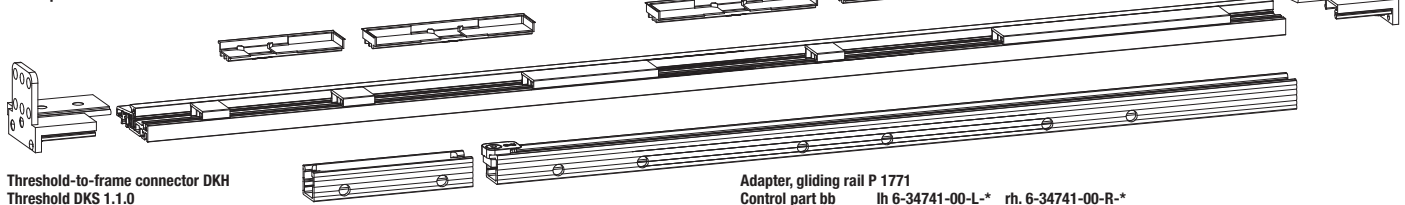

## Locking plates and positioning plates

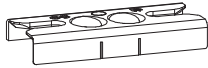

Mushroom pin locking plate



Positioning plate

### Locking plates and positioning plates for DKS threshold

Description	Groove position	Article No.
Mushroom pin locking plate	9	6-32207-18-0
Mushroom pin locking plate	13	6-32584-00-0
Positioning plate	9	9-44573-00-0
Positioning plate	13	9-44572-00-0

### Adapters for locking plates and positioning plates for DKS threshold

Description	Groove position	Article No.
Adapter for mushroom pin locking plate	9	9-43106-09-0
Adapter for mushroom pin locking plate	13	9-43106-13-0
Adapter positioning plate	13	9-43106-13-0

The profile-specific locking plates for timber and PVC joinery are to be taken from the order catalogues "Builder's Hardware for timber windows and patio doors (H)" and "Builder's Hardware for PVC windows and patio doors (K)".

### Important advice:

All specifications required for ordering DKS thresholds and accessories can be found in the catalogues "Builder's Hardware for timber windows and patio doors" (H), edition 09.09 page 2.96 et seq., and "Builder's Hardware for PVC windows and patio doors (K), edition 09.09, page 2.86 et seq.

Advice on mounting G.U-966/100 oZ bb fittings:

- For timber joinery refer to drawing No. 0-44964
- For PVC joinery refer to drawing No. 0-45399

---

Gretsch-Unitas GmbH  
Baubeschläge  
Johann-Maus-Str. 3  
D-71254 Ditzingen  
Phone +49 (0)7156 301-0  
Fax +49 (0)7156 301-293

BKS GmbH  
Heidestr.  
D-42549 Velbert  
Phone +49 (0)2051 201-0  
Fax +49 (0)2051 201-431